



# SPIRAL PIPE AND FITTINGS



## Round and Ready Program

- Fabricated from G90 galvanized materials
- Meets Smacna 95' high pressure standards
- Materials shipped next day direct from Hamlin warehouse

### SPIRAL PIPE

SIZE	PRICE
4" dia. 10'0" 26 ga	\$15.00
6" dia. 10'0" 26 ga	20.00
8" dia. 10'0" 26 ga	26.00
10" dia. 10'0" 26 ga	33.00
12" dia. 10'0" 26 ga	39.00
14" dia. 10'0" 26 ga	46.00
16" dia. 10'0" 24 ga	65.00
18" dia. 10'0" 24 ga	75.00
20" dia. 10'0" 24 ga	86.00
22" dia. 10'0" 24 ga	94.00
24" dia. 10'0" 24 ga	99.00
26" dia. 10'0" 24 ga	108.00
28" dia. 10'0" 22 ga	140.00
30" dia. 10'0" 22 ga	158.00

### END PIECES

#### INSIDE PLUG EP

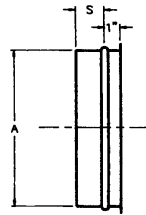

SIZE	PRICE
4"	\$4.80
6"	4.90
8"	5.50
10"	5.70
12"	6.20
14"	8.00
16"	11.50
18"	17.40
20"	18.50
22"	20.80
24"	23.00
26"	26.50
28"	31.70
30"	35.40

#### OUTSIDE CAP EC

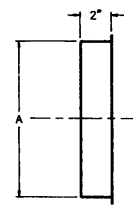

SIZE	PRICE
4"	\$4.80
6"	4.90
8"	5.50
10"	5.70
12"	6.20
14"	8.00
16"	11.50
18"	17.40
20"	18.50
22"	20.80
24"	23.00
26"	26.50
28"	31.70
30"	35.40

### ELBOWS

#### DIE STAMPED 90° E-90-1

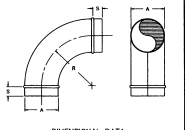

#### GORED ELBOW E-90-5, E-45-3

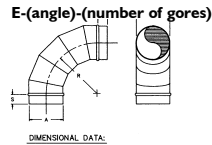

SIZE	PRICE
4" SE90	\$10.30
6" SE90	12.40
8" SE90	19.60
10" E90-5	28.40
12" E90-5	40.60
14" E90-5	48.50
16" E90-5	59.10
18" E90-5	87.20
20" E90-5	100.50
22" E90-5	118.10
24" E90-5	132.20
26" E90-5	140.40
28" E90-5	186.10
30" E90-5	214.00

SIZE	PRICE
4" SE45	\$9.10
6" SE45	11.40
8" SE45	13.20
10" E45-3	20.80
12" E45-3	24.50
14" E45-3	29.30
16" E45-3	44.20
18" E45-3	48.70
20" E45-3	53.40
22" E45-3	61.00
24" E45-3	66.00
26" E45-3	71.50
28" E45-3	86.20
30" E45-3	94.20

### COUPLINGS

#### PIPE COUPLING S-1

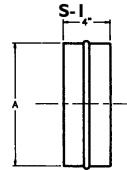

SIZE	PRICE
4" Internal	\$3.10
6" Internal	3.20
8" Internal	3.90
10" Internal	5.20
12" Internal	5.90
14" Internal	6.70
16" Internal	7.70
18" Internal	8.50
20" Internal	8.80
22" Internal	9.30
24" Internal	10.30
26" Internal	12.20
28" Internal	13.90
30" Internal	15.30

#### FITTING COUPLING S-2

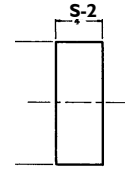

SIZE	PRICE
4" External	\$3.10
6" External	3.20
8" External	3.90
10" External	5.20
12" External	5.90
14" External	6.70
16" External	7.70
18" External	8.50
20" External	8.80
22" External	9.30
24" External	10.30
26" External	12.20
28" External	13.90
30" External	15.30



- Materials shipped FOB from Hamlin warehouse in Benson, NC.
- Freight cost added to order

L. R. GORRELL COMPANY

PRICES SUBJECT TO CHANGE WITHOUT NOTICE! Minimum Order is \$25.00



## Round and Ready Program

- Fabricated from G90 galvanized materials
- Meets Smacna 95' high pressure standards
- Materials shipped next day direct from Hamlin warehouse

### MINI BELLMOUTH

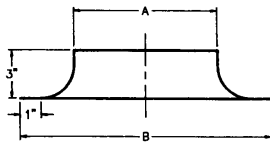

SIZE	PRICE
4" MR BM	\$6.40
6" MR BM	7.00
8" MR BM	8.10
10" MR BM	11.00
12" MR BM	11.50
14" MR BM	17.20
16" MR BM	26.00
18" MR BM	31.70
20" MR BM	36.90
22" MR BM	40.90
24" MR BM	46.70
26" MR BM	83.60
28" MR BM	93.90
30" MR BM	102.60

### CONCENTRIC REDUCER

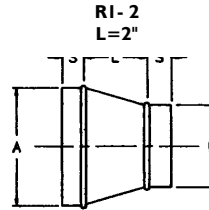

SIZE	PRICE
6x4 R1-2	\$12.30
8x6 R1-2	14.70
10x8 R1-2	15.80
12x10 R1-2	17.20
14x12 R1-2	21.20
16x14 R1-2	25.00
18x16 R1-2	30.80
20x18 R1-2	34.80
22x20 R1-2	38.80
24x22 R1-2	40.90
26x24 R1-2	47.30
28x26 R1-2	55.30
30x28 R1-2	58.80



SIZE	PRICE
8x4 R1-4	\$17.70
10x6 R1-4	18.80
12x8 R1-4	20.50
14x10 R1-4	25.10
16x12 R1-4	29.70
18x14 R1-4	36.60
20x16 R1-4	41.50
22x18 R1-4	46.00
24x20 R1-4	48.70
26x22 R1-4	56.30
28x24 R1-4	65.80
30x26 R1-4	70.00

### STRAIGHT SADDLE TAP TST

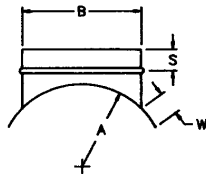

SIZE	PRICE	SIZE	PRICE
4" TST on Flat	\$5.20	4" TST on 06"	\$9.10
6" TST on Flat	3.70	6" TST on 08"	10.40
8" TST on Flat	4.40	8" TST on 10"	12.60
10" TST on Flat	4.90	10" TST on 12"	14.30
12" TST on Flat	5.60	12" TST on 14"	15.80
14" TST on Flat	7.10	14" TST on 16"	17.20
16" TST on Flat	7.20	16" TST on 18"	18.00
18" TST on Flat	9.00	18" TST on 10"	18.90
20" TST on Flat	9.70	20" TST on 22"	19.80
22" TST on Flat	14.60	22" TST on 24"	20.80
24" TST on Flat	19.80	24" TST on 26"	22.50
26" TST on Flat	21.20	26" TST on 28"	25.60
28" TST on Flat	22.70	28" TST on 30"	27.00
30" TST on Flat	24.30		

### STRAP & BRACKET

SIZE	PRICE
Bracket #BA3	\$ .90
1" strap, galv., 250' roll	38.00

### ACCESS DOOR

SIZE	PRICE
8X4 on 06"	\$23
8X4 on 08"	23
8X4 on 10"	23
8X4 on 12"	23
8X4 on 14"	23
8X4 on 16"	23
12x8 on 18"	30.20
12x8 on 20"	30.20
16x12on22	42.30
16x12on24	42.30
16x12on26	42.30
16x12on28	42.30
16x12on30	42.30

### SEALER

SIZE	PRICE
ProSeal	\$21.00



- Materials shipped FOB from Hamlin warehouse in Benson, NC.
- Freight cost added to order

## ACCESS DOORS

### ACCESS DOORS

Model **ADC** with Cam Latches (No Hinge)

Sizes In Inches	Price Each
6 x 6	\$11
8 x 8	12
10 x 10	14
12 x 12	15
14 x 14	19
16 x 16	21
18 x 18	24
24 x 24	36

- **DOOR PANEL**  
24 gauge Galvanized Steel
- **FRAME**  
22 gauge Galvanized Steel
- **INSULATION**  
1" Fiberglass
- **PRE-FORMED TABS**  
20 gauge Galvanized Steel

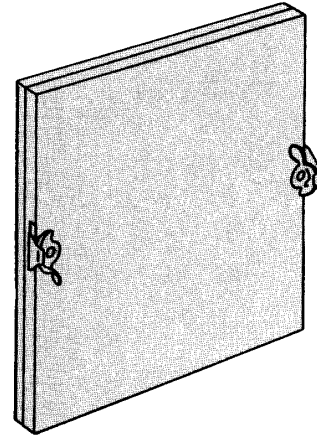

**Notes:**

- 1" thick door w/double wall construction.
- 1" insulation and cam latches
- For sheet metal duct applications

### ACCESS DOORS FOR ROUND DUCT

Model **DRU** (uninsulated) and Model **DRI** (insulated)

Door Size	Duct Size	Model	Price Each	Model	Price Each
8" x 4"	5" - 6"	DRU-08x04-06	\$24	DRI-08x04-06	\$33
	7" - 9"	DRU-08x04-09	24	DRI-08x04-09	33
	10" - 11"	DRU-08x04-11	24	DRI-08x04-11	33
12" x 8"	10" - 11"	DRU-12x08-11	34	DRI-12x08-11	46
	12" - 14"	DRU-12x08-14	34	DRI-12x08-14	46
	15" - 16"	DRU-12x08-16	34	DRI-12x08-16	46
	17" - 18"	DRU-12x08-18	34	DRI-12x08-18	46

**Note:**

Model DRU is uninsulated, Model DRI is insulated

- No measuring (Self-Adhesive Template Provided)
- Effortless Opening & Closing (No Tools Required)
- Tested to 20" W. G. Positive & 10" Negative
- Completely Airtight
- No Frames To Install Or Seal

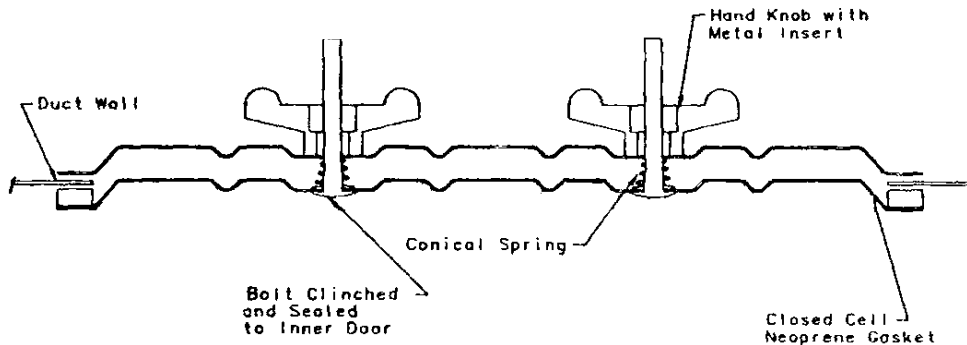

L. R. GORRELL COMPANY

PRICES SUBJECT TO CHANGE WITHOUT NOTICE! Minimum Order is \$25.00

## LOUVERS & VOLUME CONTROL DAMPERS

### ARROW UNITED EXTRUDED ALUMINUM LOUVERS

Model **EA-405** - 4" Deep, 450 Baffle Blade - Stationary - Standard Channel Type

Size	Price	Flange Kit* Price Each
12 x 12	\$69	\$18
18 x 18	105	26
24 x 12	94	26
24 x 24	134	35
30 x 16	148	35
36 x 24	164	43
36 x 36	255	53
48 x 48	389	70

\* Flange Kit to be Field Installed



SPECIFICATIONS	
<b>MATERIAL:</b>	Extruded aluminum, 6063-T52 alloy, available in .081" thick.
<b>FACE OF LOUVER:</b>	Full jam section, with blades, head and sill contained in jamb.
<b>SCREENS:</b>	Birdscreen - 1/2" flattened expanded aluminum .051".
<b>FINISH:</b>	Mill Aluminum

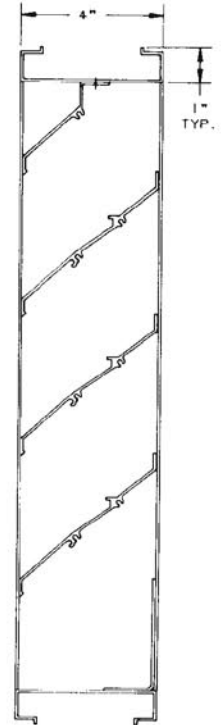
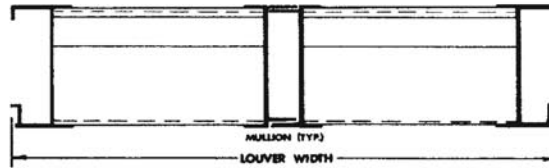

EA-405

### ARROW UNITED VOLUME CONTROL DAMPERS

Model **I770** - Galvanized Steel Control Damper

Size	Blade Arrangement	Price Each
12 x 6	Single	\$58
12 x 12	Opposed	58
18 x 12	Opposed	68
18 x 18	Opposed	88
24 x 12	Opposed	68
24 x 18	Opposed	92
24 x 24	Opposed	112
30 x 24	Opposed	122
30 x 30	Opposed	152
36 x 24	Opposed	132
36 x 36	Opposed	198

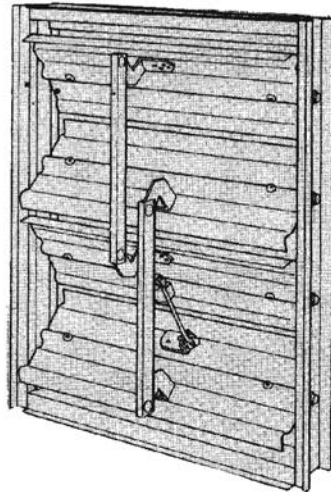

### ARROW BRICK VENTS

Model **BV, BV FL**

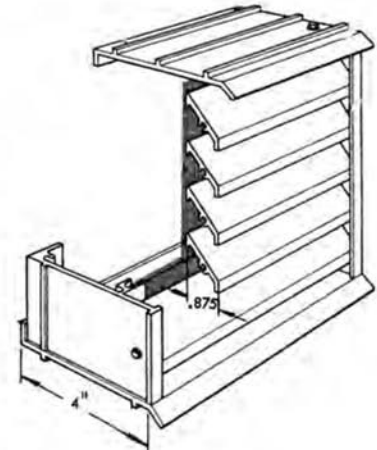

### ACTUATORS

Model	Damper Size Range	Description	Price Each
235-115	12" x 06" - 24" x 12"	115 Volt Actuator*	\$84
ML-4105B	12" x 18" -36" x 36"	115 Volt Actuator*	270
Q-37	ALL	Locking Quadrant	8

Model	Size (opening)	Price Each
BV	15 7/8" x 06" - 7 3/4"	\$68
BV FL Flanged	16 1/2" x - 7 3/4"	74

#### Notes:

- 1) 115V actuators are 2-position, spring return
- 2) ML-4105B is CCW power open, normally closed with Arrow I770 Damper. Accepts 1/2 sq. or 1/2 rd. shaft.
- 3) 235-115 is N.O. or N.C. based on motor installation

## SPIN-INS AND ROUND BALANCING DAMPERS

### COMMERCIAL METAL GASKETED SPIN-IN COLLARS

Model **ATCSI** – Gasketed "Airtite" Style Take-Off w/Locking Quadrant on 1 1/2" Standoff.

Size	Diameter	Length	Price Each
6"	5 7/8" O.D.	6"	\$11.00
8"	7 7/8" O.D.	8"	13.00
10"	9 7/8" O.D.	10"	14.00
12"	11 7/8" O.D.	12"	16.00
14"	13 7/8" O.D.	12"	20.00
16"	15 7/8" O.D.	12"	22.00



TECHNICAL DATA  
 26 Gauge Galvanized Steel  
 Locking Quadrant Operator on Standoff  
 1 1/2" Wide Flange  
 1/8" Double Stick Neoprene Gasket

### COMMERCIAL ROUND BALANCING DAMPER

Model **RBD** – 7 1/2 " Long Body

Size	Diameter	Price Each
6"	5 7/8" O.D.	\$19.00
8"	7 7/8" O.D.	21.00
10"	9 7/8" O.D.	24.00
12"	11 7/8" O.D.	26.00



TECHNICAL DATA  
 20 Gauge Galvanized Steel  
 Heavy Duty Metal Quadrant  
 1 1/2" Stand Off Bracket  
 Die Cast Metal Slide Pin & Control Rod  
 Bronze Bushings

L. R. GORRELL COMPANY

PRICES SUBJECT TO CHANGE WITHOUT NOTICE! Minimum Order is \$25.00

# SQUARE TO ROUND AND ROUND TO ROUND TRANSITIONS

## SQUARE TO ROUND TRANSITIONS

Model **SRT**

Sizes In Inches	Price Each
6 x 6 x 6	\$4
8 x 8 x 6	5
8 x 8 x 7	5
8 x 8 x 8	5
9 x 9 x 7	6
9 x 9 x 8	6
9 x 9 x 9	6
10 x 10 x 8	6
10 x 10 x 9	6
10 x 10 x 10	6
12 x 12 x 10	7
12 x 12 x 12	7
15 x 15 x 12	9
15 x 15 x 14	9
18 x 18 x 16	11
20 x 20 x 14	14
20 x 20 x 16	14
20 x 20 x 18	14
22 x 22 x 12	16
22 x 22 x 16	16
22 x 22 x 18	16

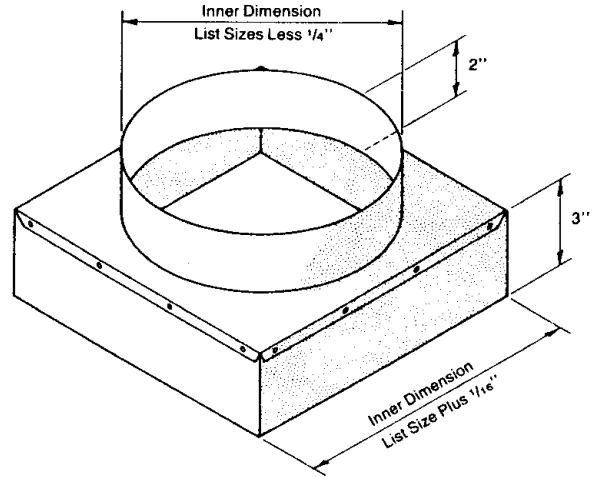

**TECHNICAL DATA:**  
 Round Neck Sized 1/8" Under  
 Square Neck Sized 1/4" Over  
 Made of 28 gauge Galvanized Steel

## ROUND TO ROUND REDUCERS

Model **RRT**

Sizes In Inches	Price Each
6" to 5"	\$4
8" to 6"	4
10" to 8"	6
12" to 10"	6
14" to 12"	8
16" to 14"	10

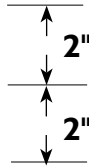

**TECHNICAL DATA:**  
 Inner Round Neck Sized 1/8" Under  
 Outer Neck Sized 1/8" Under  
 Made of 28 gauge Galvanized Steel

Concentric Round Reducers and Bellmouth Take-Offs may be found on page 31.

L. R. GORRELL COMPANY

## FLEXIBLE DUCT/CLAMPS, , AND TIE STRAPS

### FLEXIBLE DUCT

#### Type F114

- Positive 10" W.G.
- 25 - foot lengths

Diameter	Price Each
06"	\$31
08"	36
10"	41
12"	48
14"	58
16"	68

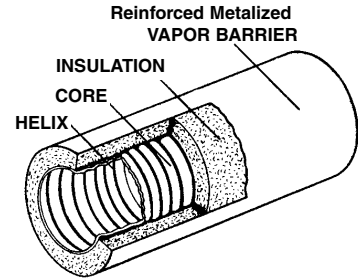

Type F114 is a UL 181 Class I Air Duct which meets the requirements of NFPA 90A and 90B. Factory installed with fiber, it has a durable, scuff resistant polyethylene jacket. A continuous full internal core using an encapsulated wire, which helix completely shields the air flow from fiberglass erosion.

The F114 series is designed for use in low-to-medium pressures in HVAC systems.

The 25-foot lengths are shipped compressed for easy handling.

### HEAVY-DUTY ADJUSTABLE CLAMPS

- An approved installation method for certain types of flexible duct under UL 181 standards of installation.
- 100% Nylon Clamps adjustable from 2" to 10" in diameter.
- For neck sizes larger than 12", combine two straps

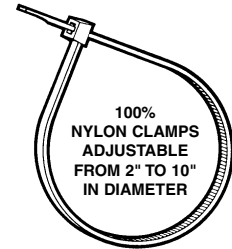

### TOOLS - Model T150

- Fast tensioning
- Excess clamp material is trimmed with cutter
- Competitively priced
- Made in America



Model	Price Each
Tyton Clamp - 36" Long	\$ 0.29
Tyton T150 Tool	76.00

# VIBRATION ISOLATOR

## FLOOR MOUNTS

### Type "T22" Single Deflection Rubber-In-Shear Isolator

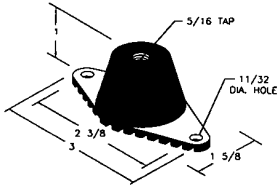

Model Number	Color Code	Rated Load	Rated Defl.	Price Each
T22	BLACK	40#	.25	\$7

### Type "T44" Single Deflection Rubber-In-Shear Isolator

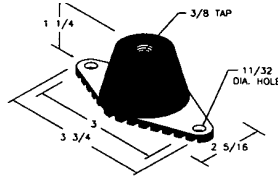

Model Number	Color Code	Rated Load	Rated Defl.	Price Each	
T44	3A	BLACK	100#	.25	\$8
	5A	BLUE	150#	.25	8
	7A	GREEN	300#	.25	8

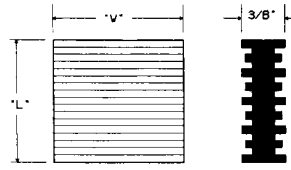

SERIES "NNP" RIBBED NEOPRENE ISOLATION PAD

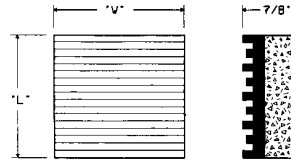

SERIES "CNP" COMBINATION CORK AND NEOPRENE ISOLATION PAD

Series "NNP" and "CNP" isolation pads have a recommended load rating of 50 lbs./sq. in. Minimum load is 25 lbs./sq.in. Maximum load is 70 lbs./sq. in.

Series "NNP" and "CNP" isolation pads are furnished with the ribs alternately raised and lowered to provide rated deflection over the rated load range.

Series "NNP" isolation pads have a deflection of .125"

Series "CNP" isolation pads have a deflection of .1875"

Model/Size	Price
NNP - 18" x 18"	\$65
NNP - 4" x 4"	5
CNP - 18" x 18"	94
CNP - 2" x 2"	2

## HANGING ISOLATORS

Model HS-L and HS-I hangers with steel spring and neoprene noise isolation washer

Model HES-I hangers with steel spring and neoprene hanger element

Part Number	Rated Load Lbs	Spring Deflection	Dimensions In Inches					Price Each	
			L	W	H	F	A		B
HES-1-121	45-90	1.90"	3-1/2	2	9-1/4	4-5/8	1	3/4	\$48
HES-1-122	90-120	1.90"							
HES-1-123	120-175	1.90"							
HES-1-124	175-250	1.80"							
HES-1-125	250-330	1.80"							
HES-1-126	330-450	1.80"							
HES-1-127	450-600	1.70"							
HES-1-128	600-750	1.70"							

Part Number	Rated Load Lbs	Spring Deflection	Dimensions In Inches						Price Each
			L	W	H	F	A	B	
HSL-1-101	25-50	1.20"	2-3/4	2	4-1/2	3-1/8	7/8	5/8	\$18
HSL-1-102	50-100	1.20"							
HSL-1-103	100-150	1.20"							
HSL-1-104	150-250	1.10"							
HS-1-121	45-90	1.40"	3	2	7	4-5/8	1	3/4	\$26
HS-1-122	90-120	1.40"							
HS-1-123	120-175	1.40"							
HS-1-124	175-250	1.30"							
HS-1-125	250-330	1.30"							
HS-1-126	330-450	1.30"							
HS-1-127	450-600	1.20"							
HS-1-128	600-750	1.20"							

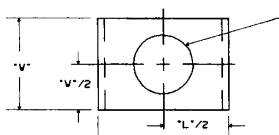

"A" Diameter Hole Top and Bottom for Maximum "B" Diameter Hanger Rod by Others

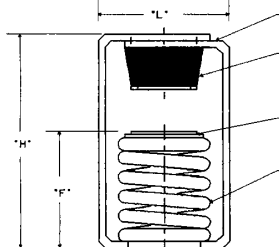

Heavy Duty Hanger Box  
Double Deflection (1/2") Molded Neoprene Element  
Steel Washer  
Stable Steel Spring

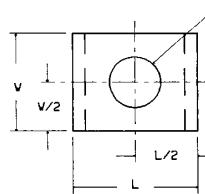

"A" Diameter Hole Top and Bottom for Maximum "B" Diameter Hanger Rod by Others

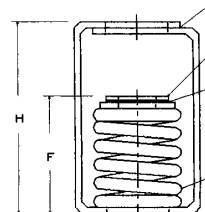

Heavy Duty Hanger Box  
Steel Washer  
Neoprene Isolation Washer  
Stable Steel Spring

L. R. GORRELL COMPANY

PRICES SUBJECT TO CHANGE WITHOUT NOTICE! Minimum Order is \$25.00